



## **HIGH PRESSURE PIG SIGNALER MODEL UNI-TEC 200-TLF-10**

### **GENERAL SPECIFICATIONS**

Uni-Tec Model 200-TLF-10 is a mechanical sphere and pig passage indicator with visual signal and manual reset. The unit is pressure balanced without the use of dynamic seals. The indicator is designed for mounting on a Wireloc® Clamp Assembly by using a branch Tee or fully reinforced Weld-O-Hub.

### **INSTALLATION INSTRUCTIONS**

#### **IMPORTANT**

The dimension from the top of the 3WL23 Weld-O-Hub to the pipe is 6.000" and must be held to tolerance in order for the indicator to function properly. The indicators are made in accordance with the specific pipe size and wall thickness for each application, and may not be interchanged from pipe size to another having different dimensions.

#### **ASSEMBLY**

1. Inspect components prior to assembly. Hub and Seal Ring seating surfaces must be clean and free from foreign matter. Damage to the Hub seats are not acceptable and should be rectified prior to assembly.
2. Install seal ring in accordance with Wireloc® standard "Assembly Procedures".
3. Insert Model 200-TLF-10 onto seal.
4. Assemble Clamp around Hubs and tighten bolts in a uniform manner in accordance to Wireloc® standard "Assembly Procedure".



## **FLAG OPERATION**

The Flag assembly has been factory set, however, if this has been changed, then;

1. Remove reset knob protector.
2. To reset Flag, turn the knob located on the front of the housing in a clockwise motion. This will cause the Flag to rotate and automatically lock in position.
3. When the pigging device passes, the probe will be displaced from the pipeline and upon moving approximately 1/8" will cause the Flag to move into tripped position. The Flag will then be readily visible through the viewport.
4. To reset the Flag, repeat operation number 2.

***Note: The action of the Flag is independent of exterior, shaft seals or the reset mechanism. Dust, rain or icing conditions will not affect its operation.***

## **FLAG ADJUSTMENT AND SERVICING**

The Flag assembly is factory sealed and will not require field servicing. The only adjustment that may be required is the positioning of the viewports to the desired line of sight. To accomplish this, loosen set screw on the side of the Flag housing and rotate the assembly 90° to the right or left. Should the Flag trip indicating pig passage during this operation, it is a sign that the Flag is too sensitive. To overcome this, rotate the Flag assembly 360° counter clockwise and retighten set screw.

## **SPARE PARTS**

Properly installed, the detector will operate indefinitely without the warehousing of spare parts.

CAD DRAWING. NO MANUAL CHANGES ALLOWED. DO NOT GUESS. IF IN DOUBT, ASK.

GENERAL NOTES:

UNLESS OTHERWISE SPECIFIED

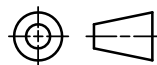

M/

LTS: 300090-07748-3B0002  
HEAT NO.  
W.O. NO.  
P.O. NO.

NOTICE: PROPRIETARY RIGHTS INVOLVED  
THIS DOCUMENT AND ALL ACCOMPANYING INFORMATION AND DATA ARE AND REMAIN THE PROPERTY OF LTS, INCORPORATED, AND ARE NOT TO BE COPIED, REPRODUCED, REPRODUCED, NOR TRANSMITTED OR DISCLOSED TO OTHERS WITHOUT EXPRESS PERMISSION AND ARE TO BE RETURNED UPON REQUEST THEREFOR. ALL RIGHTS IN PROPRIETARY AND NOVEL FEATURES OF THE SUBJECT MATTER ARE EXPRESSLY RESERVED BY LTS, INC. RECIPIENT'S AGREEMENT TO THE FOREGOING IS INDICATED BY ACCEPTANCE OF THIS DOCUMENT.

REVISIONS				
ZONE	LTR	DESCRIPTION	DATE	CHECKED
OWC				

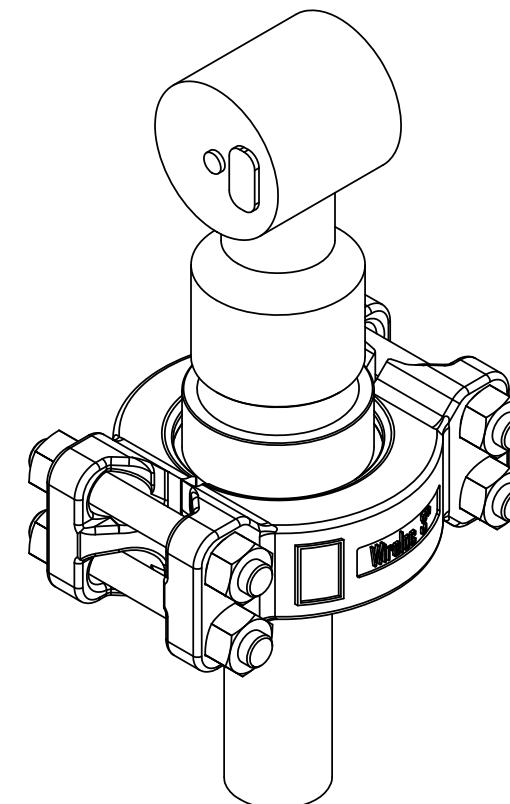
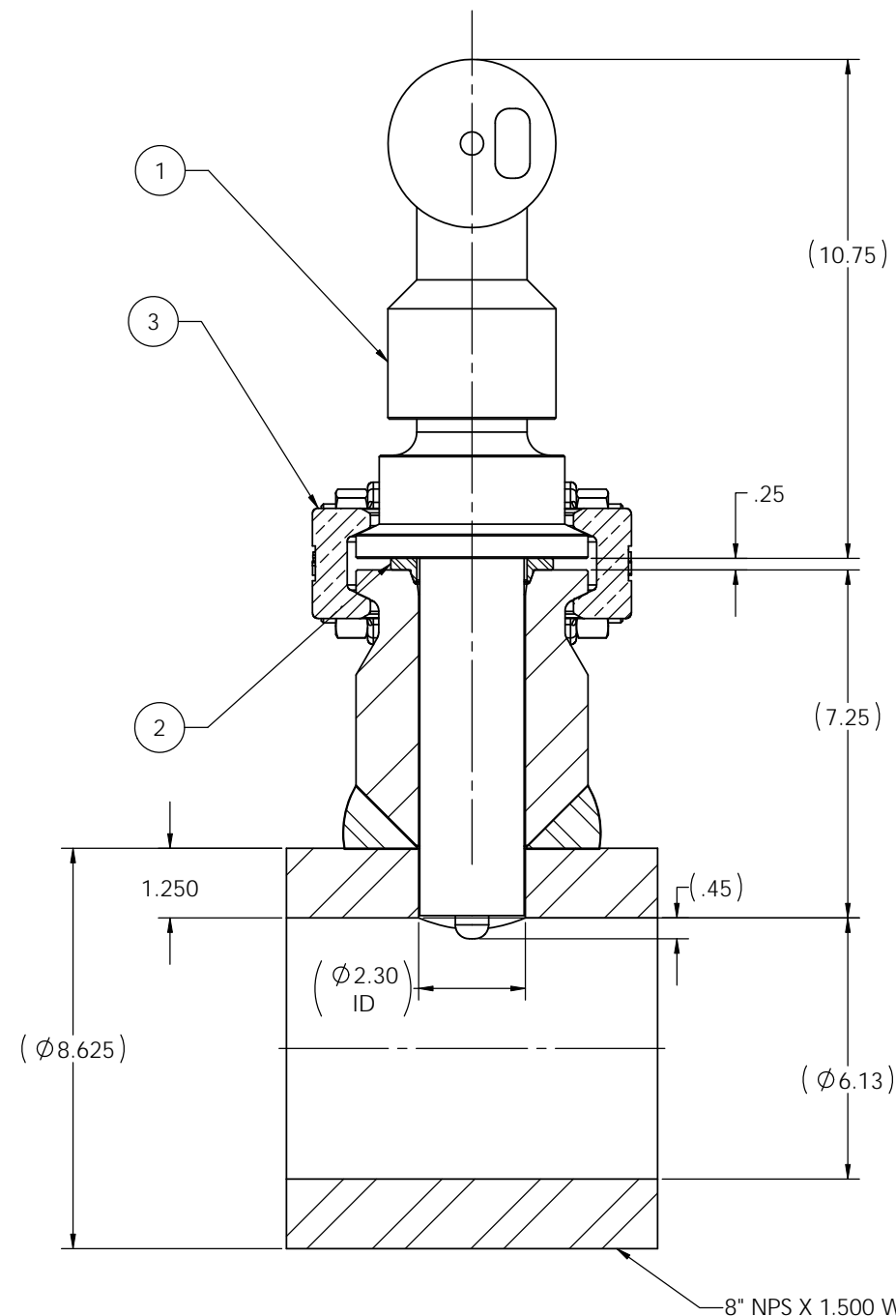
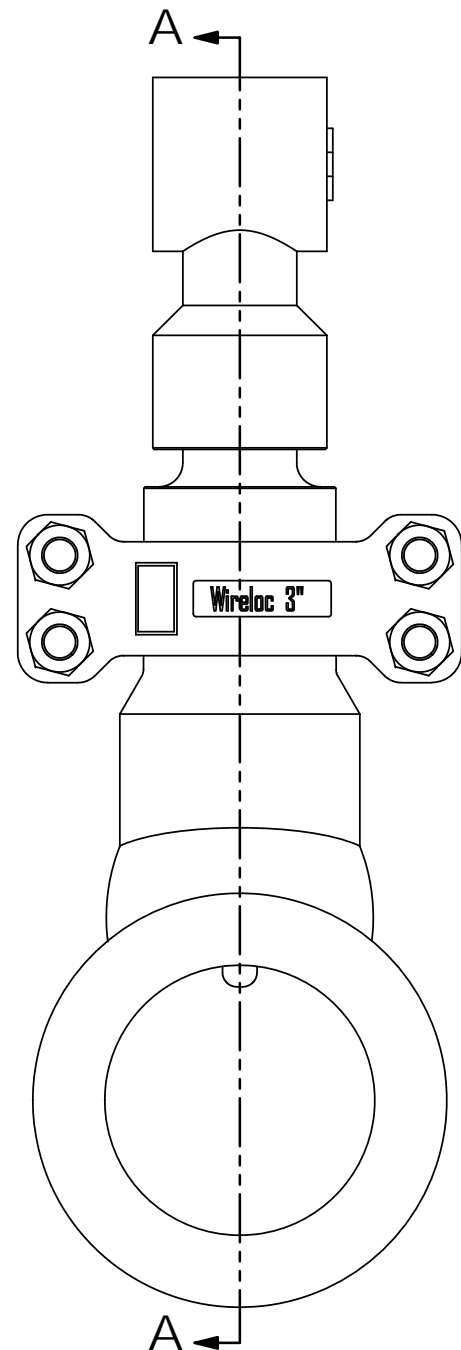

ITEM NO.	QTY.	PART NO.	MATERIAL	DESCRIPTION
1	1	900095-07748	A182 F51/316 SS	PASSAGE INDICATOR
2	1	401233-P000230-00	A17.4PH-PTFE	SEALRING, Wireloc™ SIZE 23
3	1	435057-103016-01	AISI 4140 / A 193 B7	CLAMPSET, 3" Wireloc™ - XYLAN

SECTION A-A

UNSPECIFIED TOLERANCES	
.X ± .1	FRACTIONAL ± 1/16"
.XX ± .03	ANGULAR ± 1/2°
.XXX ± .015	CONCENTRICITY .005 TIR

UNLESS OTHERWISE SPECIFIED

- DIMENSIONS ARE IN INCHES
- INTERPRET DRAWING IAW AMERICAN NATIONAL STANDARDS INCLUDING APPLICABLE DOCUMENTS REFERENCED THEREIN.
- INTERPRET DIMENSIONS AND TOLERANCES IAW ANSI Y 14.5.
- MACHINED FILLETS .030 R .010
- SURFACE FINISH SHALL BE IAW ANSI B 46.1
- DIMENSIONS TO BE MET PROTECTIVE COATING.
- REMOVE ALL BURRS, BREAK SHARP EDGES .010 R MAX.
- Δ INDICATES CROSS REFERENCE TO A NOTE.
- MPS SIGNIFIES REFERENCE TO LTS ENGINEERING MATERIAL AND PROCESS SPECIFICATIONS.

ACCESS: 1	STATUS: A	PREPARED	G BROWN	29 JUN 04
DO NOT SCALE PRINT		CHECKED	K. PELATA	
MATERIAL:		ENGINEER	G BROWN	
SEE BOM		MFG		
		QA		
		APPROVED	K. PELATA	
		APPROVED		
M & P		ENGR SVC		

<b>LTS</b>		Houston, Texas, U.S.A.	
PIG PASSAGE INDICATOR			
KIDD-UNI-TECH MDL 200 TLF-10 x			
3WL23 WIRELOC™ HUB			
SIZE	CODE IDENT NO.	DRAWING NO.	
D		GA PIG-SIG 200	
SCALE	1:2	WT.	LBS
		SHEET 1 OF 1	